

Getting to Know Your **2012 Enclave**



Review this Quick Reference Guide for an overview of some important features in your Buick Enclave. More detailed information can be found in your Owner Manual. Some optional equipment described in this guide may not be included in your vehicle.

If you have additional questions about the features and controls in your vehicle, press the blue OnStar button to speak with a customer assistance representative who can provide more information.

Instrument Panel

Turn Signal Lever/
Windshield Wipers Lever

Cruise Control
Buttons

Instrument
Cluster

Audio Steering
Wheel Controls



Exterior Lamps
Control

Instrument Panel Illumination
Control/Dome Lamp Off Button

Tilt/Telescopic Steering
Wheel Control

Symbols



StabiliTrak/
Traction Control



Oil Pressure



Check Engine or
Tighten Gas Cap



Charging System



Airbag Readiness



Cruise Control Set



BRAKE Brake System



Engine Coolant
Temperature



Antilock Brake
System



Security



Low Tire Pressure



Safety Belt Reminder

Driver Information Center Buttons

USB Port (inside storage compartment)

Audio System/Navigation System◆

Hazard Warning Flashers Button

Climate Controls



Driver's Heated/Cooled Seat Buttons◆

Rear Wiper Switch/
Traction Control Off Button/
Tow/Haul Mode Button◆/
Power Liftgate Switch

Accessory Power Outlet

Passenger's Heated/Cooled Seat Buttons◆

Note: Refer to your Owner Manual to learn about the information being relayed by the lights, gauges and indicators of the instrument cluster, as well as what to do to ensure safety and prevent damage.

◆ optional equipment

See Instruments and Controls in your Owner Manual.

Driver's Seat

Power Controls

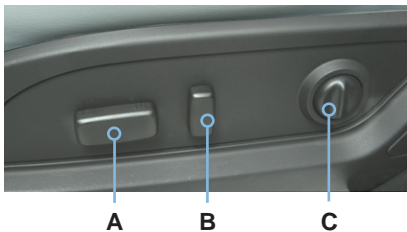

A. Seat Adjustment

Move the horizontal control to move the seat forward or rearward and to raise, lower or tilt the seat.

B. Seatback Recline Adjustment

Move the vertical control to recline or raise the seatback.

C. Lumbar Adjustment (*optional*)

Press the switch to adjust the amount of lumbar support.

Manual Lumbar

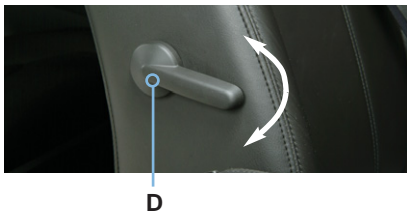

D. Lumbar Adjustment

Pull up/push down the lever on the inboard side of the seatback to adjust the amount of lumbar support.

Head Restraint

The head restraint is in a forward position to meet the Insurance Institute for Highway Safety (IIHS) performance criteria for rear impacts.

- To raise the head restraint, pull it up.
- To lower the head restraint, press the release button on the head restraint post and push it down.

See Seats and Restraints in your Owner Manual.

Enter or Exit the 3rd-Row Seats



A

1. Make sure nothing is on the 2nd-row seat or the floor in front of or behind the seat.
2. Fold up the armrest(s).
3. Rotate the release lever (A) on the upper-outboard side of the seatback forward.
4. Push the top of the seatback forward. The seat cushion will fold and the entire seat will slide forward.
5. After entering/exiting, push the top of the seatback rearward until the seatback and floor tracks lock.
6. Push down at the rear of the seat cushion to lock it in place.

Slide the Seat

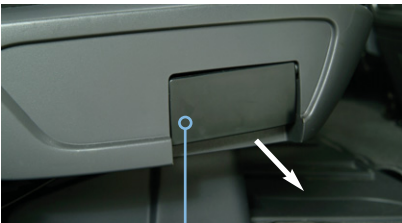

B

1. Make sure nothing is on the floor in front of or behind the 2nd-row seat.
2. Pull outward on the handle (B) on the outboard side of the seat cushion and slide the seat forward or rearward.
3. Release the handle.

Fold/Recline the Seatback



C

1. Make sure the seat is all the way rearward (when folding the seat) and the armrest(s) are upright.
2. Pull forward on the strap (C) on the outboard side of the seatback.
3. Fold down or recline the seatback.

See Seats and Restraints in your Owner Manual.

Exterior/Interior Lighting

Automatic Headlamp System



 Off/On

AUTO Automatic Headlamp System

Activates the Daytime Running Lamps (DRLs) in the daytime and the headlamps and other exterior lamps at night or when necessary.

Parking Lamps

Manual operation of the parking lamps.

Headlamps

Manual operation of the headlamps.

Fog Lamps

Press the knob to turn the fog lamps on or off.

Instrument Panel Lighting



Instrument Panel Brightness

Turn the small knob to increase or decrease the instrument panel lighting. Turn the knob fully to turn on the dome lamps when all doors are closed.

Dome Lamp

Dome Lamp Off

Press the button to turn off the dome lamps. **With the button depressed, the dome lamps will not turn on when a door is open.**

Press the button again to have the dome lamps turn on when a door is open.

See Lighting in your Owner Manual.

Front Seat Control

Press the **REAR** button (A) on the front climate control panel to turn the rear climate control system On or Off. The button indicator will illuminate when the rear system is On.

- The rear system operates in Mimic Mode, with the rear settings the same as the driver's settings, when the **REAR** button is pressed.
- The rear system operates in Independent Mode when any of the rear settings are adjusted using the rear seat controls.



Rear Seat Control

Fan controls

Air delivery modes:
 Vent
 Bi-level
 Floor

Temperature controls



Rear climate controls with rear seat audio (optional) shown.

Rear seat occupants can adjust the rear settings at any time by using the rear controls, regardless of the front control panel REAR setting.

- To turn on the rear system, press any rear control.
- To turn off the rear system, turn the left knob to the **Off** position, or press the down **Fan Control** repeatedly (*rear climate controls with rear seat audio*).

See Climate Controls in your Owner Manual.



Set Cruise Control

1. Press the  **On/Off** button. The button indicator will illuminate when the system is on.
2. When traveling at the desired speed, press the **SET-** button to set the speed. The  **Cruise Control** symbol will illuminate on the instrument cluster.

Adjust Cruise Control

RES+ Resume/Accelerate

Press to resume a set speed.

When the system is active, press to increase speed.

SET- Set/Coast

When the system is active, press to decrease speed.

Cancel

Press to cancel the cruise control but retain the set speed in memory.

The cruise control set speed is erased when cruise control or the vehicle ignition is turned off.

See Driving and Operating in your Owner Manual.



Note: An iPod® or a USB storage device connected to the USB port, located in the upper instrument panel storage compartment, can be controlled using the audio controls.

+ ▸ - Volume

Pull up the + or - button to increase or decrease the volume.

▴ ▾ Next/Previous

Press the up or down arrow to go to the next or previous favorite radio station, CD track or DVD chapter (*optional*).

SRCE Source

Press to select an audio source.

Press and hold for one second to initiate voice recognition on the navigation system (*optional*).

▸▹ Seek

Press to go to the next radio station on the same band, CD track or DVD chapter (*optional*).

📞 Mute/Push to Talk

Press to mute the vehicle speakers.

Press and hold for two seconds to interact with the OnStar or Bluetooth system.

📞 End

Press to end or reject an OnStar or a Bluetooth call.

Bluetooth® System

A Bluetooth-enabled cell phone must be paired with the in-vehicle Bluetooth system before it can be used in the vehicle. Not all phones will support all functions.

Visit www.gm.com/bluetooth for more information.

See Instruments and Controls in your Owner Manual.

Rear Wiper/Washer

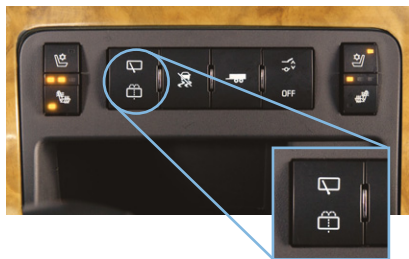

Rear Wiper

Press the top of the switch to turn the rear wiper on or off.

Washer Fluid

Press the bottom of the switch to spray washer fluid on the rear window.

See Instruments and Controls in your Owner Manual.

Power Liftgate



Power Liftgate Switch

- Press the **Power Liftgate OFF** switch to turn off the power liftgate. The liftgate can only be operated manually when the power liftgate switch is in the Off position.
- Press the top of the **Power Liftgate** switch to turn on the power liftgate.

Note: If the power liftgate does not open or close, make sure the power liftgate switch is not in the Off position.

Open/Close the Power Liftgate

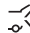
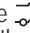
- Press and hold the  **Power Liftgate** button on the Remote Keyless Entry transmitter until the liftgate starts moving.
- Press the top of the  **Power Liftgate** switch on the center console.
- Press the touchpad (A) above the liftgate handle to open.
- Press the touchpad (B) next to the liftgate latch to close.

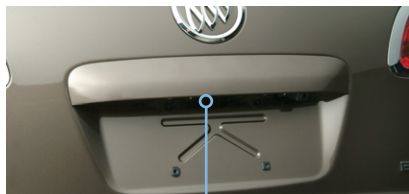

A



B

See Keys, Doors and Windows in your Owner Manual.

Wind Noise

If a rear window is open, there may be a buffeting wind noise inside the vehicle. Opening a front window slightly when a rear window is open will prevent this noise from occurring.

See Keys, Doors and Windows in your Owner Manual.

Towing

The Enclave base towing capacity is 2,000 lbs. Vehicles equipped with the Trailer Towing Package have a towing capacity of 4,500 lbs.

Use the Tow/Haul mode (*optional*) when pulling a heavy trailer to reduce the frequency of transmission shifts and improve the control of vehicle speed.

- To turn the Tow/Haul mode on or off, press the  Tow/Haul button on the center console.

See Vehicle Care in your Owner Manual.

Battery Location

The battery is located beneath the floor behind the front passenger seat.

Jump-start positive and negative posts are located under the hood on the passenger's side of the vehicle.

See Vehicle Care in your Owner Manual.

Tire Pressure Monitor

The Tire Pressure Monitor alerts you when the tire pressure in any tire becomes too low by illuminating the  **Low Tire Pressure** warning light on the instrument cluster. The warning light will remain on until the tire pressure is corrected by adding the proper amount of air to the tire(s). Refer to the Tire & Loading Information label in the driver's door opening for the recommended tire pressures. Once the tires are properly filled with air, drive the vehicle and the warning light will turn off.

You may notice during cooler outdoor temperatures that the low tire pressure warning light will turn on when the vehicle is first started and then turn off as you drive and tire pressure expands. This may be an early indicator that your tire pressures are getting low and the tires need to be inflated to the correct pressure.

Note: *The Tire Pressure Monitor can alert you about low tire pressure, but it doesn't replace normal monthly tire maintenance. It is the driver's responsibility to maintain correct tire pressures.*

See Vehicle Care in your Owner Manual.

Roadside Assistance

1-800-252-1112

TTY Users: 1-888-889-2438

As the owner of a new Buick, your vehicle is automatically enrolled in the Buick Roadside Assistance program for 5 years/100,000 miles at no expense to you. This value-added service is intended to provide you with peace of mind as you drive in the city or travel the open road.

Buick's Roadside Assistance toll-free number is staffed by a team of technically trained advisors who are available 24 hours a day, 365 days a year, to provide minor repair information or make arrangements to tow your vehicle to the nearest Buick dealer.

Roadside Assistance and OnStar

If you have a current OnStar subscription, press the OnStar button and the vehicle will send your current GPS location to an OnStar Advisor who will speak to you, assess your problem, contact Roadside Assistance and relay your exact location so you will get the help you need.

myBuick and OnStar® Mobile Apps



The myBuick and OnStar mobile apps connect owners to a variety of vehicle information and services, such as a searchable Owner Manual, real-time fuel information and Roadside Assistance, as well as enable users to perform Remote Keyless Entry transmitter commands, including locking and unlocking the doors and starting the vehicle.



An active OnStar account is required to use the OnStar mobile app. Visit OnStar.com for more information. Download the mobile apps from your iPhone® or Android™ device's app store.

Buick Owner Center

The Buick Owner Center, a complimentary service for Buick owners, is a one-stop resource designed to enhance your Buick ownership experience. Exclusive member benefits include online service reminders, vehicle maintenance tips, online owner manual and special privileges.

Sign up today at www.gmownercenter.com/buick.

Always demand genuine GM Parts

Certain restrictions, precautions and safety procedures apply to your vehicle. Please read your Owner Manual for complete instructions. All information contained herein is based on the latest information available at the time of printing and is subject to change without notice. Copyright 2011 by General Motors. All rights reserved.



20977797 A