

P-touch TZE TAPE ELECTRONIC LABELING SYSTEM 1830

USER'S GUIDE

English / Español www.brother.com L18953001 Printed in China

INTRODUCTION

With your PT-1830, you can create labels for any application. Select from the many frames, character sizes and styles to design beautiful custom labels.

FCC NOTICE

This device complies with Part 15 of the FCC Rules. Operation is subject to the following two conditions: (1) This device may not cause harmful interference, and (2) this device must accept any interference received.

GENERAL PRECAUTIONS

- Use only Brother TZE tapes with this machine. Do not use tapes that do not have the TZE mark. Do not clean the machine with alcohol or other organic solvents.

1 PREPARATION

Unpacking Your P-touch Labeler

Check that the package contains the following before using your P-touch labeler.

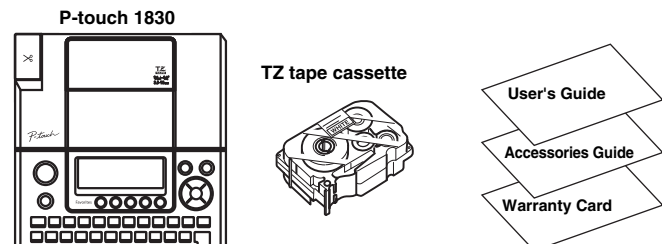

Included items may differ by distribution.

Tape Cassettes

Make sure that the power is turned off when replacing a tape cassette.

- 1 Open the tape compartment cover by lifting up both sides at the same time. If a tape cassette is already installed, remove it by pulling it straight up.

- 2 Insert a tape cassette, making sure that it snaps into place.

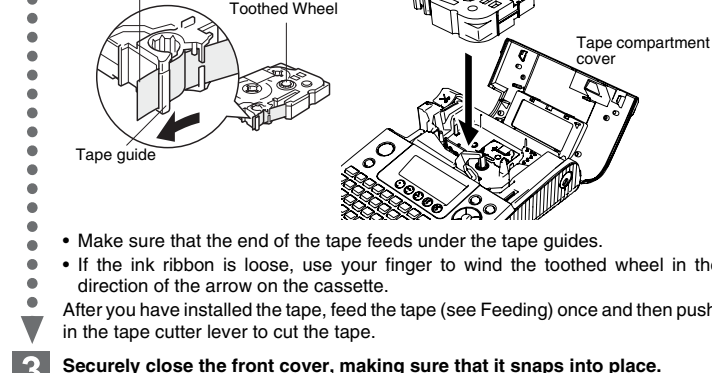

- 3 Securely close the front cover, making sure that it snaps into place.

Power Supply

- 1 Turn the machine over and remove the battery compartment cover. If batteries are already installed, remove them.

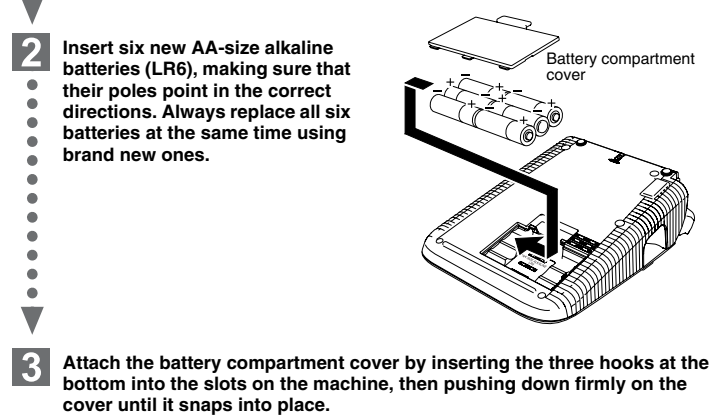

- 3 Attach the battery compartment cover by inserting the three hooks at the bottom into the slots on the machine, then pushing down firmly on the cover until it snaps into place.

2 OPERATION

Keyboard & LCD

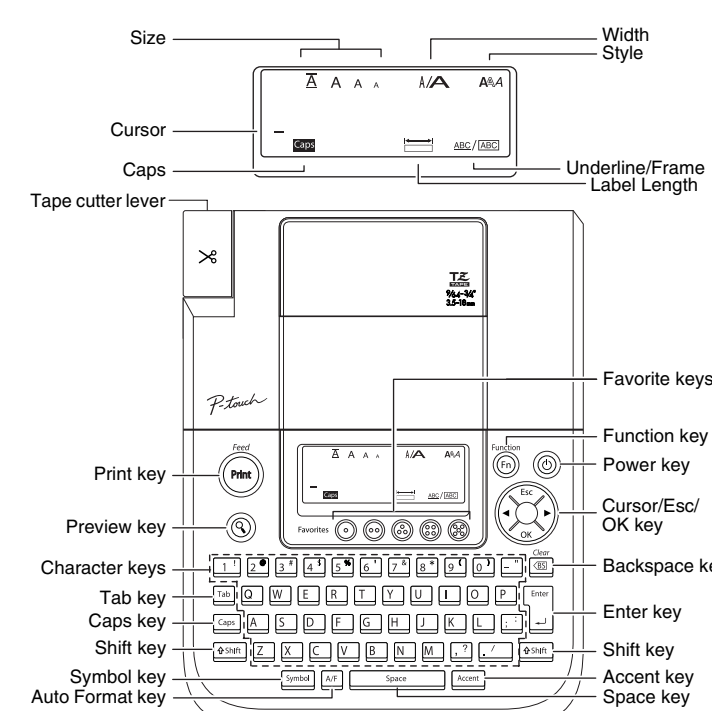

- The LCD shows one row of 15 characters; the text that you enter can be up to 80 characters in length.

Initial Setting

- 1 Start your machine. Supply power by using six AA batteries or the optional AC adapter, and then press [Power].

- 2 Set the language (English/Spanish/French/Portuguese). Choose a language with [Language] and press [Enter].

- 3 Set the unit (inch/mm). Choose a unit with [Unit] and press [Enter].

- The machine automatically turns off if no key is pressed within 5 minutes.

See the under side for steps of creating labels.

3 REFERENCE

Troubleshooting

Table with columns: Message, Cause/Remedy. Includes messages like Battery Weak!, Check Battery!, Invalid!, No Text!, Line Limit!, No Cassette!, Cutter Error!, Full!, Text Too Long!, No Frame OK?

What to do when...

Table with columns: Problem, Solution. Includes problems like display blank, machine does not print, printed characters not formed, memory cleared, blank horizontal line, machine locked up.

Specifications

Table with columns: Item, Specification. Includes Dimensions, Weight, Power supply, Tape cassette.

Accessories (Supplies may differ by distribution.)

Table with columns: Accessories, Stock No. Includes Tape Cassettes, AC Adapter, Carrying Case.

[CREATING LABELS]

1 MAKING TEXT

Switching Upper Case/Lower Case

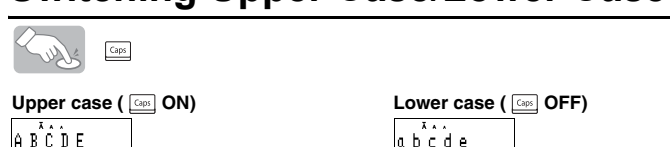

Making Two Line Text

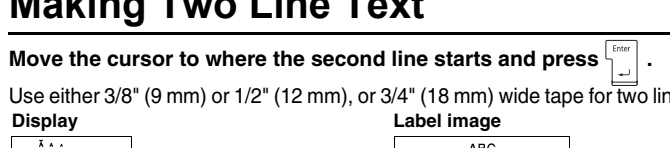

Entering Symbols

Table showing symbol groups and their corresponding keyboard shortcuts.

Table showing accented characters and their corresponding keyboard shortcuts.

Entering Accented Characters

Table showing various accented characters like A, C, D, E, G, I, K, L, N, O, R, S, T, U, Y, Z and their keyboard shortcuts.

To Clear

By pressing the Backspace Key, the letters will be deleted one by one. All text and settings will be cleared.

2 DESIGNING LABELS

Setting [Size]

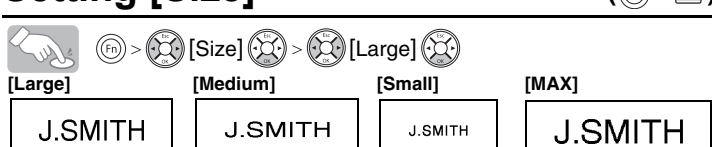

Automatically adjusts the text size according to the tape width. Select MAX to print with maximum text size when using 18 mm (3/4") tape.

Setting [Width]

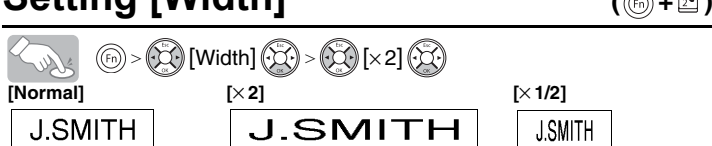

Setting [Style] (Vertical)

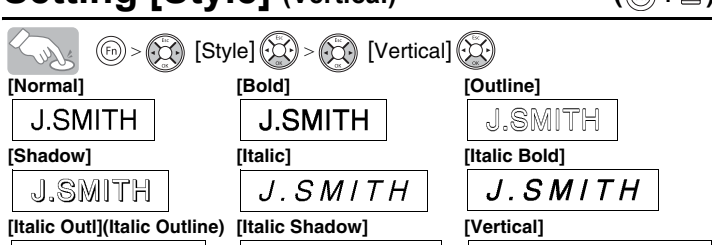

Setting [Underline/Frame]

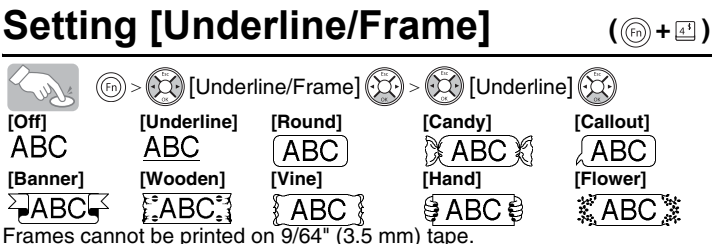

Setting [Tab]

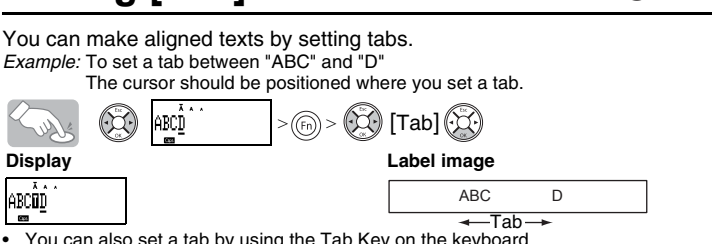

Setting [Tab Length] (Auto / 0.0" - 4.0")

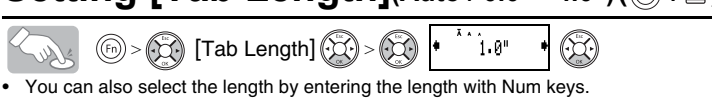

Setting [Label Length] (Auto / 1.2" - 12.0")



Setting [Auto Format]

Table showing application and length for Auto Format and VHS Spine options.

3 PRINTING LABELS

Text Preview

You can preview the text before printing. The LCD shows the whole text and the label length (inch/mm), then returns to the original text.

Printing

- To cut off the label, push in the tape cutter lever on the upper-left corner of the machine.

Feeding (Tape Feed)

- The machine will feed (put in amount) of tape, which may be needed when installing a new tape cassette or when using the [Chain Print] feature.

Setting [Margin] (Tape Margin)

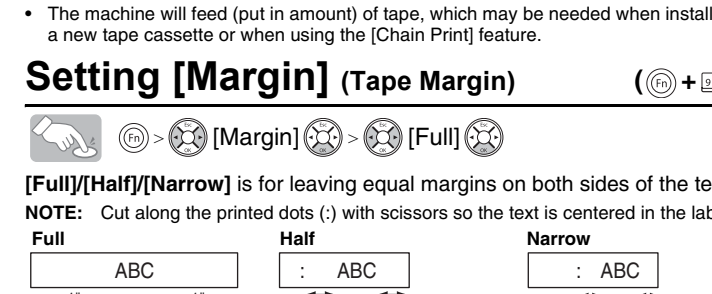

[Chain Print] is for printing more than 1 copy of a label with minimum margin <e.g. 1>. You can also create a label containing text in various styles; print a text in one style, and before feeding, enter the second text in another style <e.g. 2>.

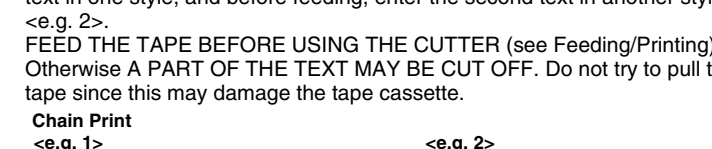

Using [Print Option]

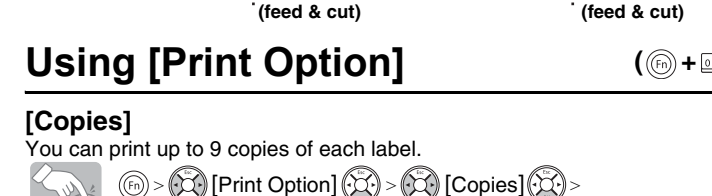

You can also select the number of copies by entering with Num keys. [Numbering]

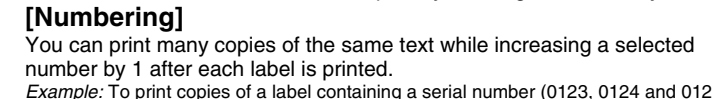

Select the highest number you wish to be printed when setting the number. [Mirror]

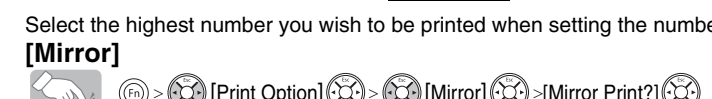

Use clear tape in [Mirror], so the labels can be read correctly from the opposite side when attached on glass, windows or other transparent surfaces.

4 COMPLETED LABELS

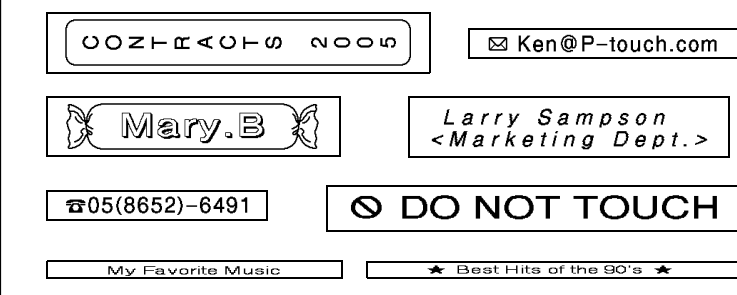

Peel the printed label from backing and apply the label.

USEFUL FUNCTIONS

Memory (Favorites)

You can save and print your favorite label in seconds at the touch of a button. There are five Favorite Keys to store your five favorite labels.

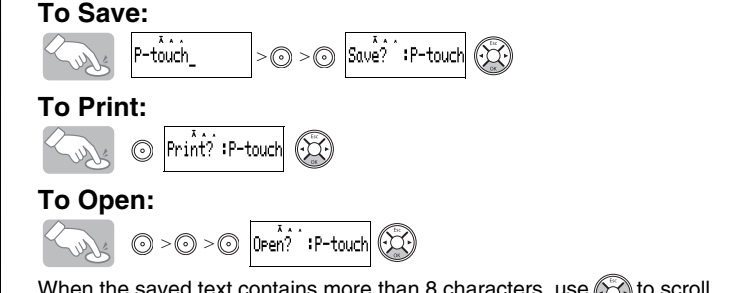

Function Shortcuts

In addition to the basic steps to search for a function, the PT-1830 provides you with function shortcuts so you can easily jump to a frequently used function just by pressing [Function] and the shortcut key shown in the table below.

Table showing function shortcuts: Key, Function, Key, Function. Includes shortcuts for [Size], [Width], [Style], [Underline/Frame], [Tab], [Tab Length], [Label Length], [Auto Format], [Margin], [Print Option].

Should you encounter any problems with your product, please do not return your product to the store! After referring to the User's guide, if you still need assistance, call Brother Customer Service at: Voice: 1-877-4-PTOUCH, Web: www.brother.com, Fax: 1-901-379-1210

If you need to locate a service center, please call 1-800-284-HELP or visit us at www.brother.com