

# Android Auto™ QUICK START GUIDE

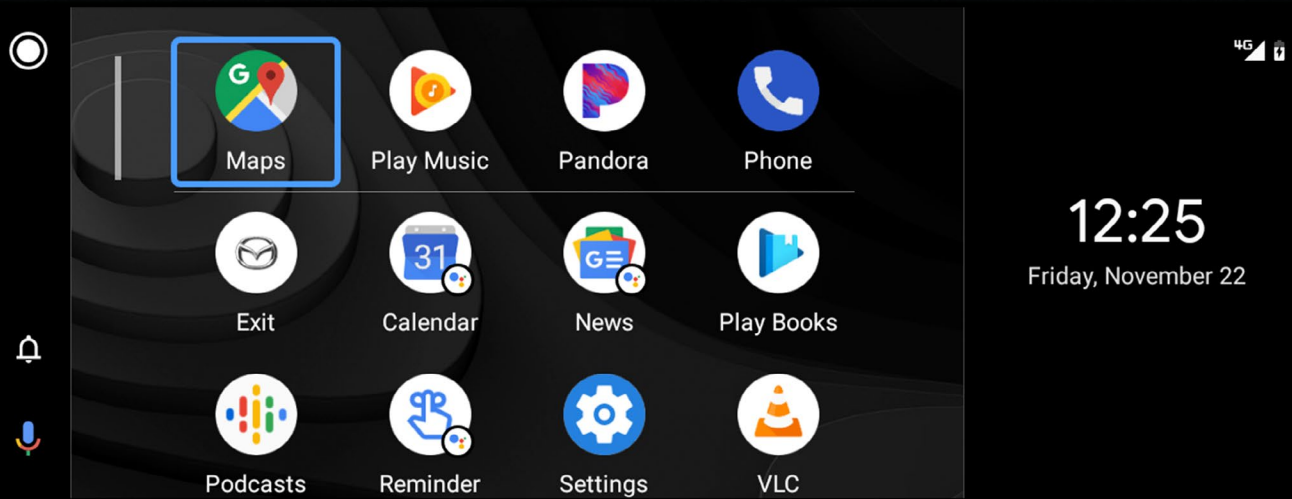

Available on select models, Android Auto™ provides convenient access to your Android™ smartphone's most useful features and apps right from your vehicle's Mazda Connect™ display, helping you stay focused on the road ahead.

Getting started with Android Auto™ is easy — simply download the Android Auto app on your Android™ device, connect to your Mazda vehicle and go!

## BASIC REQUIREMENTS

- To use Android Auto, you'll need an Android phone running 5.0 (Lollipop) or higher
- For best performance, Android 6.0 (Marshmallow) or higher is recommended
- You'll need a high-quality, certified USB cable for the in-vehicle connection
- Your Android device must be paired via Bluetooth® to use Android Auto

## GETTING STARTED

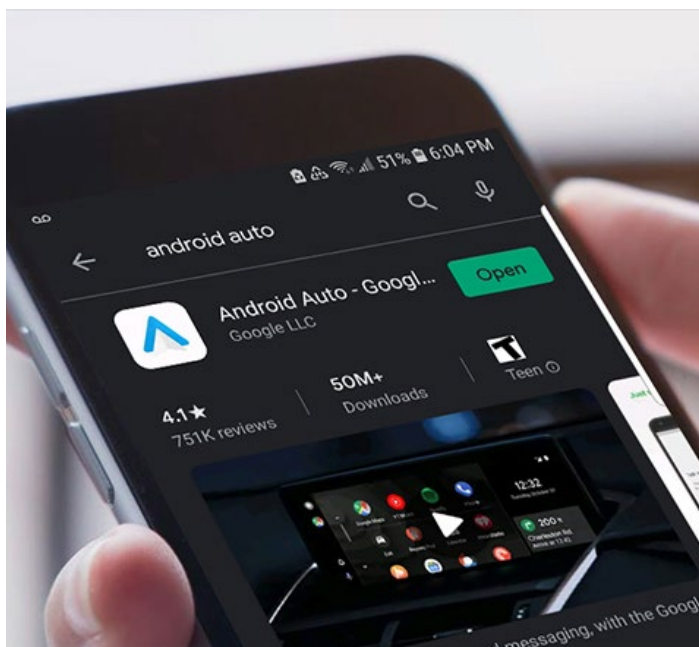

### DOWNLOAD THE ANDROID AUTO APP

- On your compatible Android mobile device, **download and install the free Android Auto app** from the Google Play™ Store
- **Launch the Android Auto app** on your mobile device
- **Follow the on-screen instructions** to complete app setup prior to connecting to your vehicle
- For the best Android Auto experience, **accept all permissions and enable notification access** for Android Auto

### CONNECT YOUR ANDROID DEVICE

- **Make sure your vehicle is in Park. The parking brake MUST be engaged** before getting started with setup
- **Connect a USB cable** to your Android device and the USB port in the center stack or inside the center armrest (depending on vehicle model)
- Mazda Connect™ will detect your device
- If you're a first-time user, **follow the on-screen prompts** to enable Android Auto (you may need to refer to your Android device to continue setup)

Once a compatible Android™ device is connected to the USB port and connected via Bluetooth®, Android Auto will launch automatically. There are also two user-friendly ways to access and get started using Android Auto from the Mazda Connect™ home screen.

## ACCESSING ANDROID AUTO



### USE THE COMMANDER CONTROL

- Once connected, the easiest way to quickly access Android Auto is to **press and HOLD the Home button** on the Commander control
- You can also **slide the Commander control to the right** when on the Mazda Connect home screen and the Android Auto icon is present

## NEW “APP LAUNCHER” HOME SCREEN

Android Auto’s home screen (aka “App Launcher” view) features three distinct sections for information – a sidebar (left), App Launcher (middle) and an Adaptive Task Bar (right) – displaying the most relevant content in an intuitive layout.

- 1 HOME BUTTON ICON
- 2 RECENTLY USED APP
- 3 NOTIFICATIONS
- 4 GOOGLE ASSISTANT™
- 5 APP LAUNCHER
- 6 ADAPTIVE TASK BAR/  
CURRENT APP CONTROLS

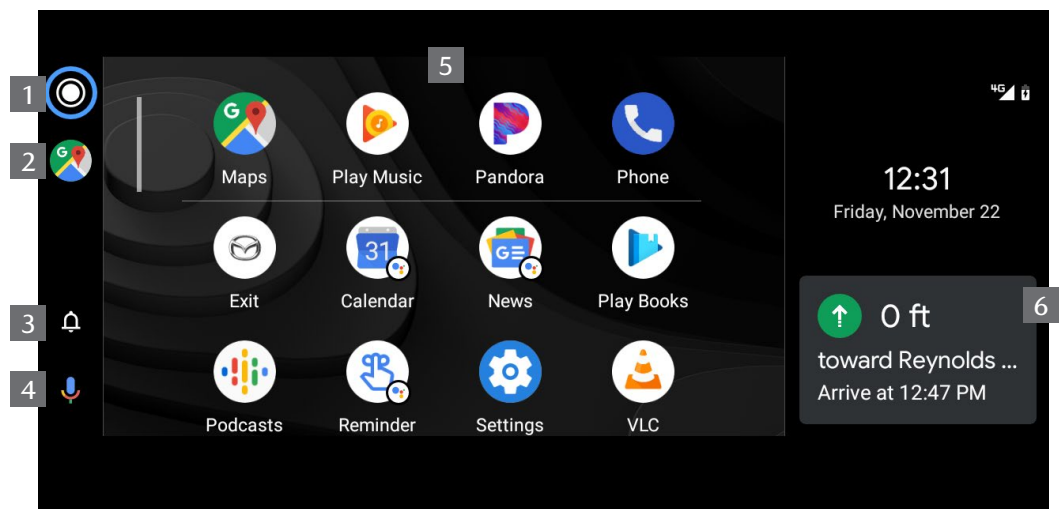

## INTERACTING WITH THE HOME SCREEN

The middle of the Android Auto home screen is the default Commander control focus area. **Rotate** the Commander control to move up and down through the list of available app tiles. **Slide** the Commander control to the left to access the sidebar. **Slide** the Commander control to the right to access the Adaptive Task Bar.

All Android Auto™ functions can be performed using Mazda's multi-function Commander control or Google Assistant™ voice commands. Enter a destination, send text messages, make phone calls and more — all without having to pick up your smartphone.

## USING THE COMMANDER CONTROL

Mazda's multi-function Commander control is designed to make interacting with Android Auto's features and functions easy and intuitive. Rotate, press or slide the Commander control to navigate through screens, apps and menus.

### COMMANDER BUTTON SHORTCUTS

- **Press and HOLD the Home button** to toggle between Android Auto and Mazda Connect™ screens
- **Press the Home button** to quickly return to the Android Auto home screen from inside Android Auto apps
- **Press the Entertainment button** to quickly access the Now Playing screen or your last-used media app
- **Press the Maps button** to quickly access the map screen or current route guidance

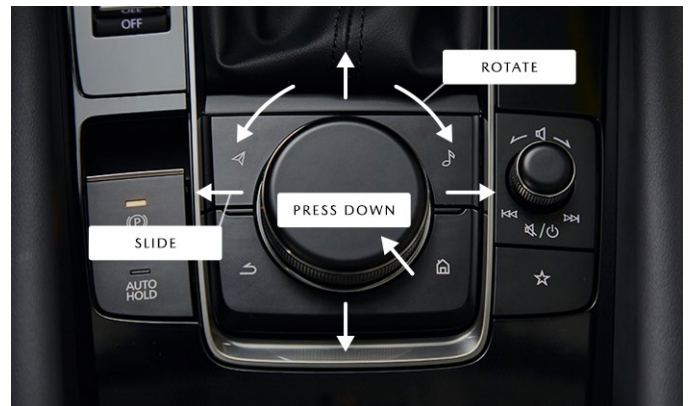

## USING GOOGLE ASSISTANT VOICE COMMANDS

Google Assistant replaces the Mazda Connect™ voice recognition system when a compatible Android™ device is connected to the vehicle's USB port. Google Assistant can be used to access many of your phone's functions while driving.

### ACTIVATING GOOGLE ASSISTANT

- **Press the "Talk" button on the steering wheel** to activate Google Assistant. Then, say your command
- Or, **slide the Commander control to the left** to access the left sidebar. Rotate the Commander control to **highlight the microphone icon**, then **press down** to activate Google Assistant
- Or, say "OK Google" while on any screen (if the feature is enabled on your device)



## FOR MORE INFORMATION

For more information on Android Auto features and functions, as well as in-depth instructions for using Android Auto, refer to the resources listed below.

- [Android Auto Help Center](#)
- [Android Auto FAQ](#)
- Owner's Manual

### SAFETY AND LEGAL

Android, Android Auto, Google, Google Play and other marks are trademarks of Google LLC.

Android Auto is provided by Google and its use is subject to your agreement to the Android Auto terms of use. When using Android Auto, location, speed, and other vehicle data is transferred to your smartphone. For further details, refer to Google's Privacy Policy. Requires compatible Android phones and standard text and data rates apply.

When using Android Auto, please avoid distraction and use Android Auto responsibly. Stay fully aware of driving conditions and always obey applicable laws.